



CANTIERE  
DELLE MARCHE

explorer's attitude

# *Acciaio 130*

*First quarter 2026 delivery*





# YACHT INTRODUCTION

Acciaio 130 is the third unit in a semi-custom series built by Cantiere delle Marche, following the successful launches of the Acciaio 105 Gatto and Acciaio 123 Astrum. Sharing its proven naval platform with the RJ 130—a vessel that demonstrated its outstanding cruising capabilities by reaching Glacier Bay, Alaska—the Acciaio 130 embodies true explorer yacht DNA.

The yacht's exterior design is characterized by an imposing flared bow, engineered to handle high seas, with a sheer line that flows seamlessly fore to aft, creating a sophisticated yachting silhouette. This elegant curvature is echoed in the fashion plates, which cascade smoothly from the top of the superstructure down to the main, upper, and sun decks, framing the yacht's signature windows.

At 415 GT, she's surely among the vessel with the largest volume. Her distinctive interiors have been penned by the award winner Giorgio Cassetta.

## **Distinctive Layout Features**

Among the most notable layout features is the partially enclosed sun deck, which houses a third salon—an ideal space for observing nature and wildlife in colder climates, or for hosting private gatherings at the highest point of the vessel.

The stern area also presents a unique concept: a full-beam staircase provides seamless access from the main deck cockpit to the swimming platform, creating a multi-level social area that is perfect for use at anchor. This inviting beach club atmosphere is further enhanced by a Finnish sauna located in the lazarette below.

The yacht accommodates up to 12 guests across five guest cabins, including a spacious on-deck owner's suite. The layout includes two Pullman beds within the guest cabins, providing flexible sleeping arrangements. A crew of seven can discreetly service the yacht via dedicated internal staircases connecting the lower and upper decks, ensuring maximum privacy for guests.

## **Performance & Efficiency**

Measuring 39.42 meters in length (130 ft) with a beam of 8 meters (26'2") and a Bahamas and Caribbean friendly draft of 2.4m (7'8"), Acciaio 130 has a displacement of approximately 388 tons and she is built for efficiency. Its hull design, featuring a bulbous bow, ensures reduced fuel consumption while delivering an impressive cruising range. Powered by two MAN engines delivering 749 kW each, the yacht reaches a top speed of 13.5 knots and offers a range of over 5,000 nautical miles at an economical cruising speed of 10 knots.

# YACHT STATUS & MAJOR UPGRADES

## *Price*

**€25.000.000 + VAT if due** (excluding Owner Supplies).

## *Classification*

Compliant to Malta commercial code, she will be registered as a Cayman pleasure vessel.

## *Included Upgrades*

- Beach club including Finnish sauna and skylights to natural lit the ambient;
- Automatically operated doors on main deck cockpit, upper deck cockpit and main deck pantry;
- Transformer Opacmare for easy access to the water and to launch water toys;
- Windbreak doors in stainless steel and glass to partially enclose the upper deck cockpit;
- Panoramic skylights on the sun deck hard top;
- Suez tonnage certificate.

## *Delivery*

First quarter 2026.



Acciaio 130 is currently under construction at Cantiere delle Marche (CDM) in Ancona, Italy. Located on Italy's Adriatic coast, Ancona is easily accessible via Ancona-Falconara Airport, which offers both domestic and select international connections. Alternatively, visitors can fly into Rome or Bologna, followed by a drive to the shipyard—approximately 3.5 hours from Rome and 2.5 hours from Bologna.

# SHORT SPECIFICATION

## Shipyard

Cantiere delle Marche

## Naval Engineer

HydroTec

## Interior Design

Giorgio Cassetta

## DIMENSIONS

### Length overall

39,4m / 130ft

### Waterline length

36m / 118,1ft

### Max beam

8m / 26,2ft

### Depth amidship

4,15m / 13,6ft

### Draught, full load

2,4m / 7,8ft

### Displacement, full load

388 Tons

## CAPACITY

### Diesel oil

54.200L

### Urea

2.600L

### Fresh water

6.500L

### Black water

1.750L

### Grey water

2.200L

### Clean oil / Dirty oil

480L / 480L

### Bilge

1.750L

## PROPULSION

### Engines

2x MAN D2862 Le428  
(749kW@2100rpm)

### Gearbox

Reintjes WAF444,  
freestanding gear ratio 4,0:1

### Generator

2x80kW CAT

### Bow thruster

85kW

### Stabilizer fins

Electrical, zero speed

## PERFORMANCE

### Maximum speed

13,5kn

### Cruise speed

10kn

### Range

5.000 @ 10kn

### Maximum speed

2x MAN D2862 Le42

## ACCOMODATION

### Passengers

12p / 5 cabins

### Crew

7p / 3 cabins

## CLASSIFICATION

Compliance to Malta commercial code,  
registred to Cayman Pleasure

# PHOTO GALLERY

## *Current status*

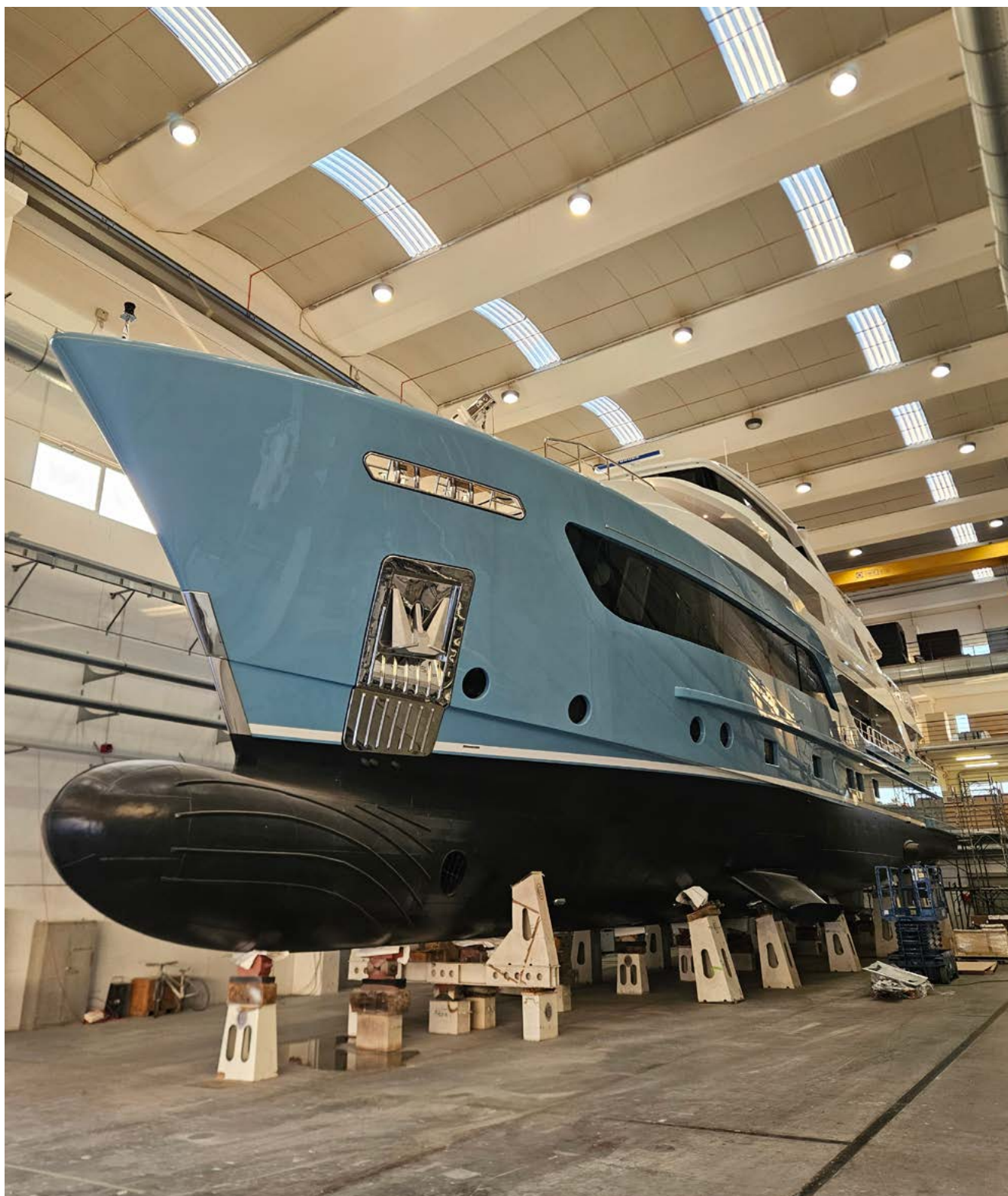







# EXTERIOR RENDERING







# GENERAL ARRANGEMENT

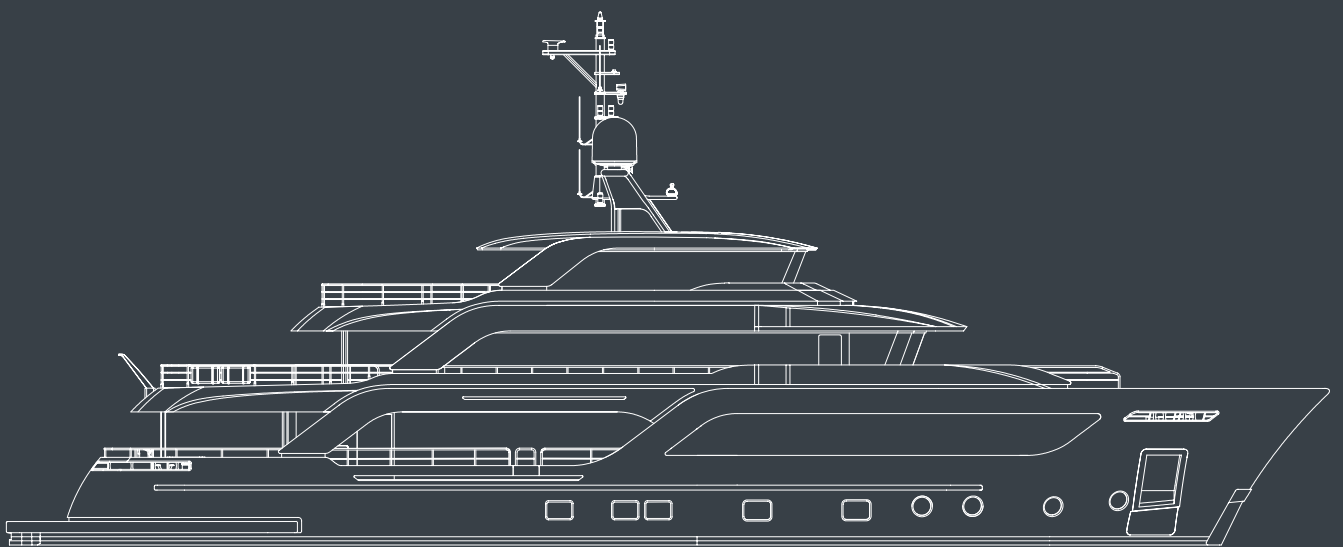

# MAIN DECK

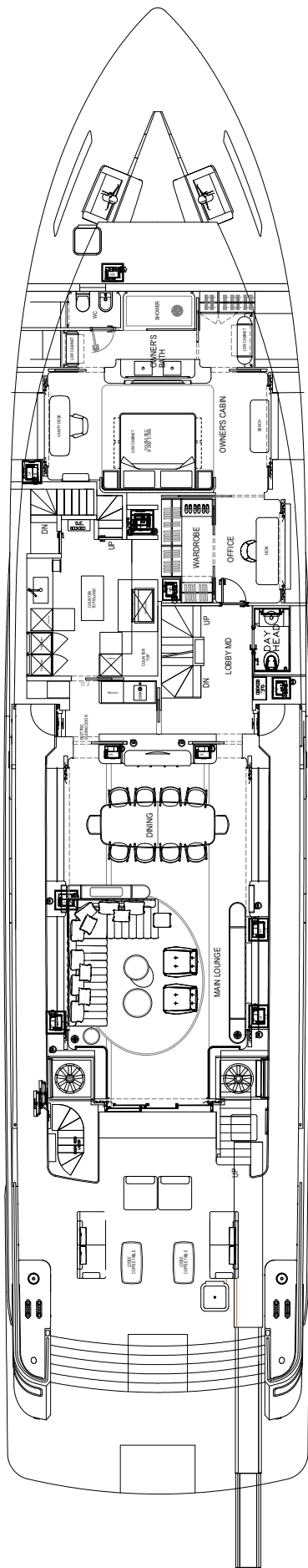

# LOWER DECK

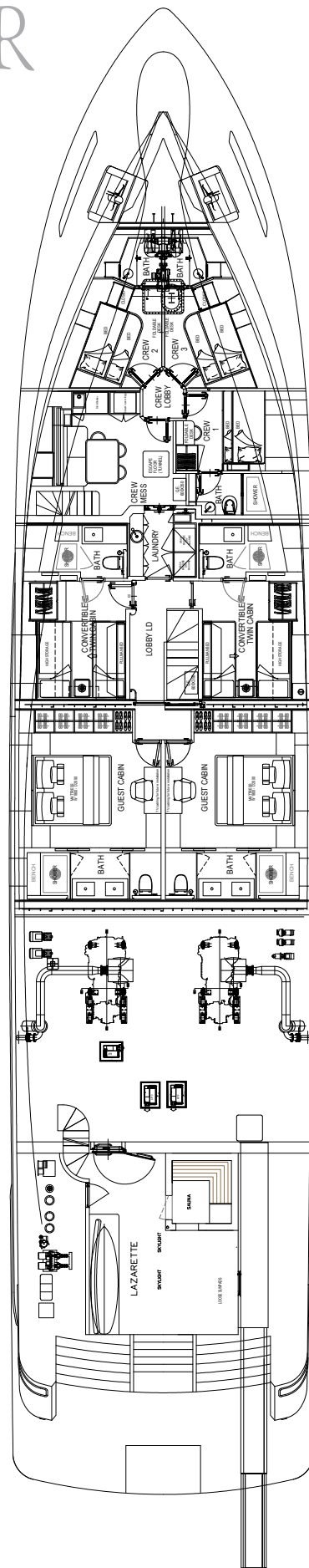

# SUN DECK

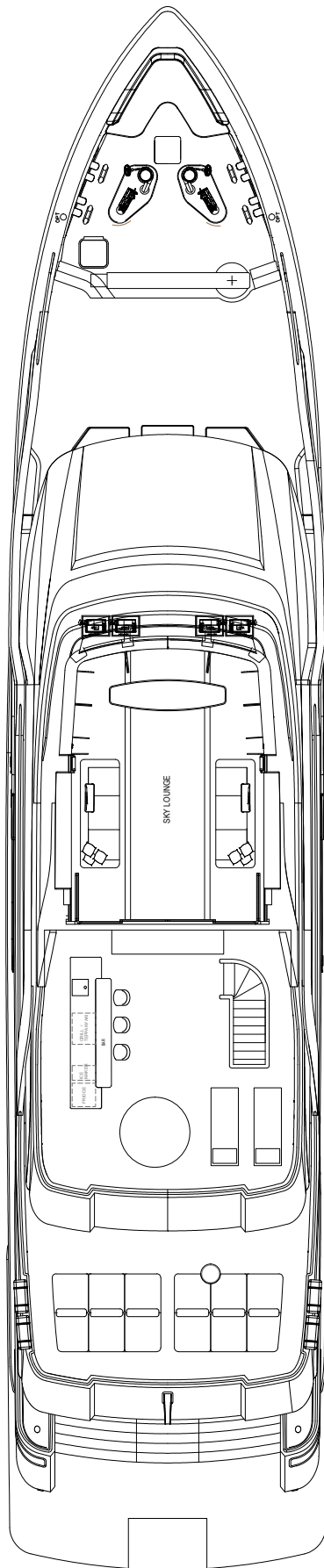

# UPPER DECK

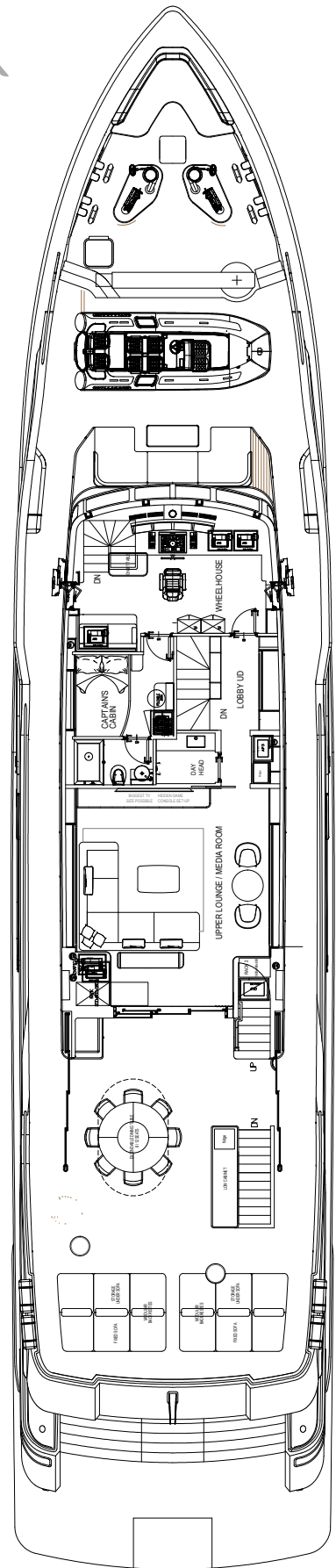

# PHOTO GALLERY INTERIORS AND EXTERIORS

*Interior Design by Giorgio Cassetta*



MAIN SALON

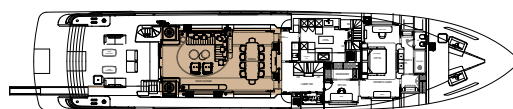



MAIN SALON

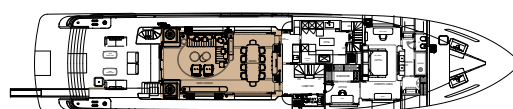



OWNER CABIN



OWNER CABIN

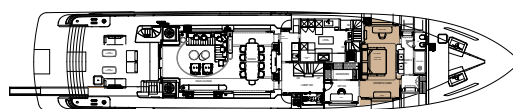



OWNER BATHROOM



OWNER OFFICE

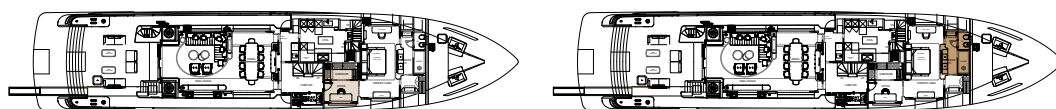



OWNER DRESSING



UPPER DECK SALON

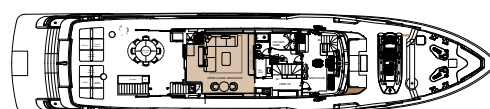
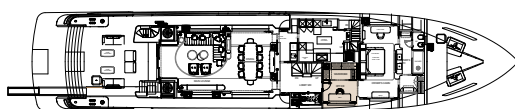



UPPER DECK SALON



SUN DECK

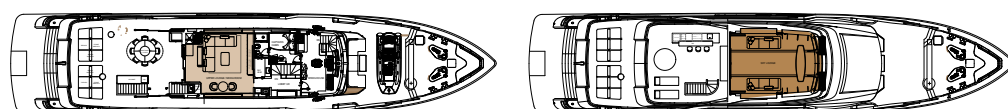



VIP CABIN



VIP CABIN

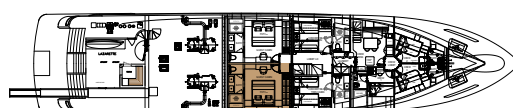



GUEST CABIN



LOBBY LOWER DECK

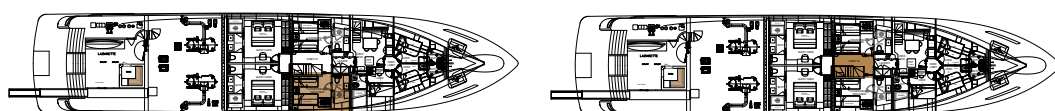

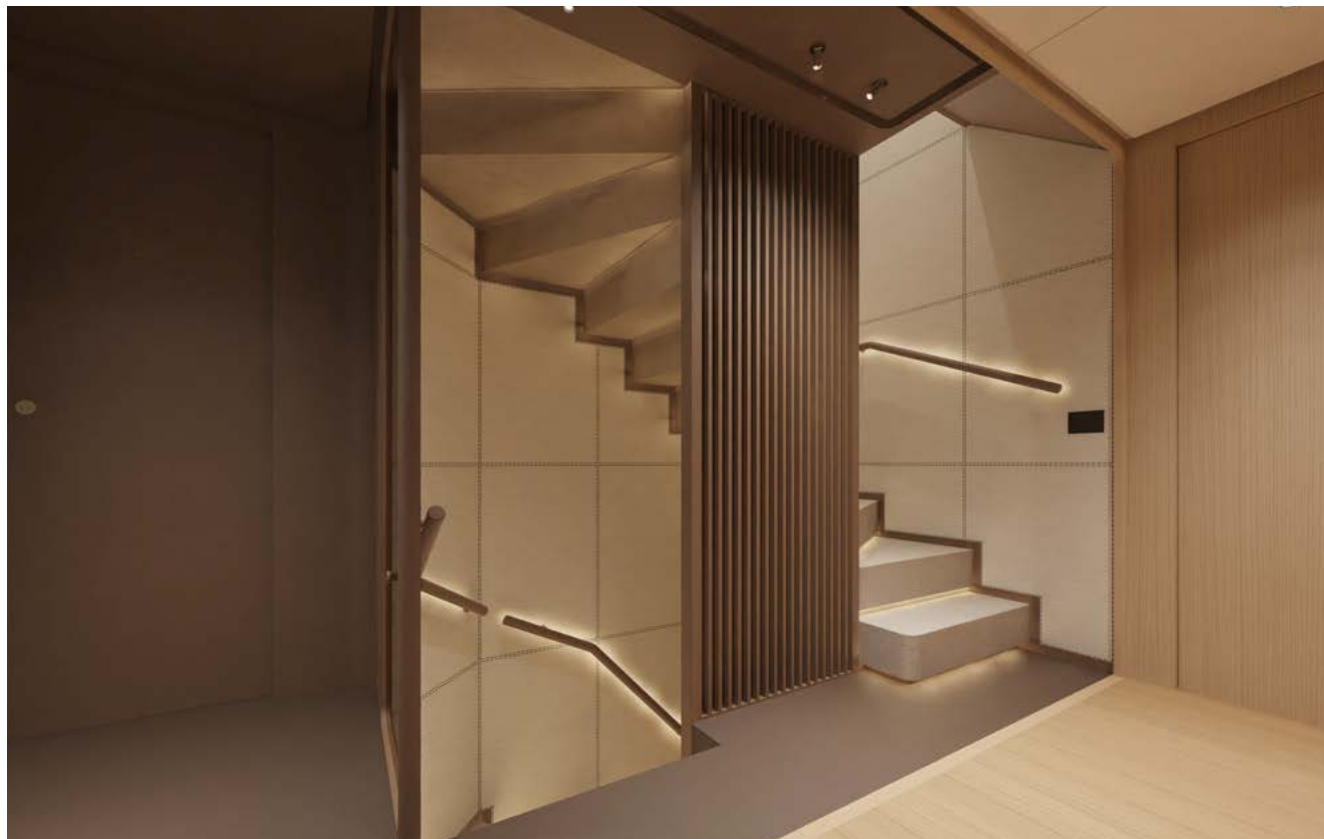

LOBBY MAIN DECK



LOBBY UPPER DECK

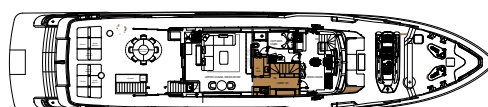
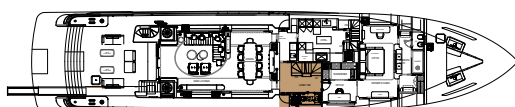



LAZARETTE



WHEELHOUSE

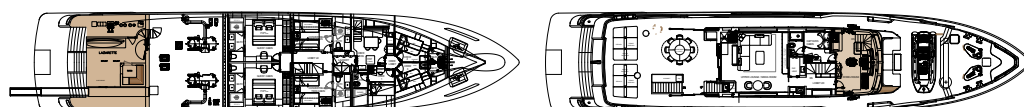



MAIN DECK



UPPER DECK



FOREDECK



SUN DECK



CANTIERE  
DELLE MARCHE  
explorer's attitude

[www.cantieredellemarche.it](http://www.cantieredellemarche.it)