

# *Darwin 102 Haze<sup>2</sup> delivered!*



CANTIERE  
DELLE MARCHE  
explorer's attitude

**D a r w i n** 102  
C L A S S

# Cantiere delle Marche announces the delivery of the *Darwin 102 Haze<sup>2</sup>*



*"We take immense pride in the Darwin Class — it represents a core achievement of our shipyard. Sixteen vessels of the Darwin Class have been launched so far, five of which are 102-foot models," says Ennio Cecchini, co-founder and President of Cantiere delle Marche. "When we introduced the Darwin Class in 2010, we combined the generous spaces and sophisticated design of a superyacht with the rugged, ocean-crossing capability of an explorer yacht, all within a compact platform. The market response and enduring popularity of this adaptable range have exceeded even our most optimistic expectations."*

The owner of Haze<sup>2</sup> first encountered the Darwin line during a visit to the 2022 Cannes Yachting Festival, where he toured a Darwin 106. Impressed by the build quality and engineering, he noted the Darwin yachts' notably deep and voluminous hulls — far more substantial than most motor yachts of similar length. He also valued their large fuel and storage capacities, which enable long-range cruising and full-season autonomy without the need for frequent refueling or resupplying.

*"All Darwin models share the same expedition-ready spirit, yet each yacht is uniquely crafted to suit its owner's lifestyle," adds Vasco Buonpensiere, co-founder and CEO. "Our ability to adapt and our consistent quality of construction were key in earning the trust of this experienced British owner, assisted by Andrew Bond of Fraser Yachts. A seasoned sailor with experience in both sailing and motor yachts, he knew exactly what he wanted from his next vessel."*

The owner worked closely with CdM to fine-tune the yacht's dimensions, exterior details, and layout. Among the custom features are a redesigned wheelhouse windscreen for better visibility and a hidden tender crane on the aft section of the Sun Deck, similar to that on the RJ series. The yacht's exterior styling, the work of Sergio Cutolo/Hydro Tec, continues the distinctive evolution of the Darwin line.







MAIN SALON

Haze<sup>2</sup> presents a striking exterior that emphasizes the bold personality of the Darwin Class, enhanced by an eye-catching metallic grey hull and blue superstructure. Inside, London-based studio Lawson Robb designed a contemporary and tactile interior that can accommodate the owners, ten guests, and a crew of five. Guided by the owner's brief - tactile finishes, light tones, open-grain wood, brushed bronze, and mosaic details - the designers created an atmosphere of refined modernity. The interplay of different veneers, metals, leather, and wall coverings brings depth and warmth, while the clean lines and fluid transitions lend an airy, structured feel. The neutral color palette, accented with occasional vibrant touches, maintains balance and serenity. Thoughtful lighting, from indirect LED ribbons tracing architectural curves to sculptural pendants, further enhances the mood, achieving a blend of comfort and understated luxury.

Measuring 31 meters in length with a beam of 7.43 meters, Haze<sup>2</sup> has a displacement of 250 tons and a Gross Tonnage of 245 GT. Powered by twin Caterpillar C18 Acert engines (500 kW each) and equipped with 40,000 liters of fuel, the yacht offers a range of over 5,000 nautical miles at a cruising speed of 9 knots. Designed for both private use and charter, Haze<sup>2</sup> has been classified accordingly.



UPPER DECK SALON

# The design of Haze<sup>2</sup> in her Owner's words



The development of Haze<sup>2</sup> was rooted in a close and ongoing collaboration between my team and Cantiere delle Marche. Together, we sought not only to refine the proven Darwin platform but to reinterpret it through a contemporary lens, one that merges advanced technical performance with an elevated design sensibility.

From the outset, design played a central role in shaping every aspect of Haze<sup>2</sup>. The introduction of a continuous wrap-around glazing system became a defining gesture, transforming the yacht's profile with a sense of lightness and fluidity. This glazing creates an almost architectural continuity between interior and exterior, visually elongating the superstructure and allowing natural light to animate the interior spaces throughout the day. While the Darwin line has always been celebrated for its robust and purposeful stance, Haze<sup>2</sup> achieves a more refined visual balance, confident yet graceful, modern yet timeless.





The exterior design was conceived as a natural evolution of the interior's aesthetic language. Surfaces were treated with the same degree of intention and restraint as interior furnishings, emphasizing proportion, rhythm, and detail. The palette, a nuanced composition of soft neutrals and deep metallic tones, introduces individuality without ostentation. Subtle gestures such as the burnt sienna bootstripe and coordinated exterior upholstery weave a visual thread between exterior and interior.

Material selection was guided by a tactile sensibility: bespoke teak elements, brushed stainless-steel accents, and hand-finished joinery all contribute to an atmosphere of craftsmanship and refinement. Every line and junction were studied to express both precision and softness, creating a yacht that feels sculpted rather than assembled.



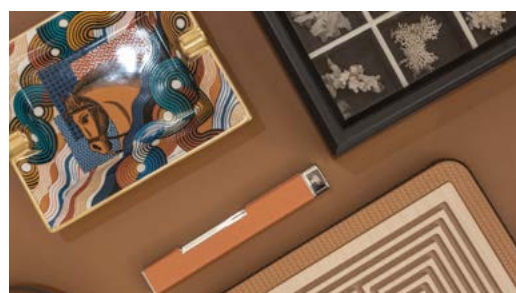

Each deck was envisioned as a sequence of landscapes, designed for versatility and effortless movement. Lounging, dining, and entertainment zones transition seamlessly, supported by careful attention to scale, sightlines, and spatial flow. Outdoor furnishings and architectural structures were tailored to complement one another, robust enough for exploration, yet refined enough for the most elegant Mediterranean settings.

At its core, Haze<sup>2</sup> reflects the dual nature of the Darwin ethos: an explorer's spirit paired with the serenity of a true home at sea. Its design celebrates contrasts — strength and delicacy, formality and ease, precision and warmth. The result is a yacht that harmonizes function, craftsmanship, and atmosphere, embodying a cohesive and contemporary evolution of the Darwin line.

Haze<sup>2</sup> stands as both a statement of design intent and a lived experience, a vessel that bridges the technical and the tactile, the adventurous and the intimate.



# Twenty questions to Steve Rigby, proud Owner of the *Darwin 102 Haze*<sup>2</sup>



## ABOUT THE OWNERSHIP AND DECISION TO BUILD

### 1. What inspired you to choose a Darwin 102 from Cantieri delle Marche?

I loved the rugged classic explorer design and together with the yard we have modernized the boat and created a new look for the Darwin.

### 2. Had you owned other yachts before this one? If so, how does the Darwin 102 compare?

I have owned an ISA (Haze) and a Swan (Mist) previously, this is a big step up in GT and scale.

### 3. What were your top priorities when beginning the custom build process?

Quality, seaworthiness, capability, design, quality of yard



## ABOUT DESIGN AND CUSTOMIZATION

### 4. How involved were you in the design and customization of the yacht?

I have run interior design businesses for 20 years (Rigby & Rigby, Helen Green and Lawson Robb) and whilst I don't do any external design anymore, I have heavily involved in my projects, I lead on FFE/ Dressing and material. George Wolstenholme leads on the interior architecture.

### 5. Were there any unique features or innovations you specifically requested?

I am a lover of artisan wallpaper, for me they are works of art. As a big fan of Murano, I also re used Vincenzi and Chan light sculptures.

### 6. What influenced the interior and exterior aesthetic choices?

The exterior colours are all Rolls Royce colours (their bespoke process is wonderful and their options some of the best) and the interior is based on ongoing research (I am always saving ideas for my next project, generally always one happening somewhere in the world).



## ABOUT PERFORMANCE AND TECHNICAL FEATURES

### 8. Why did you choose an explorer-style yacht like the Darwin series?

We want to stretch her legs and see the world.

### 9. What performance or technical features are you most excited about on board?

Range and seaworthiness.

### 10. How important was long-range autonomy and fuel efficiency in your decision?

Very, fuel efficiency and carbon footprint have to be a consideration.



#### ABOUT LIFESTYLE AND USE

**11. How do you plan to use the yacht: private family cruising, remote exploration, or a mix?**

A mix.

**12. Do you have a maiden voyage or first itinerary planned?**

She will go to Valetta for registration and then... we will see.

**13. Which regions or destinations are high on your cruising wishlist with the 102 Darwin?**

Norway / Red Sea – both on the agenda for 26/27.

#### ABOUT PARTNERSHIP WITH THE SHIPYARD

**14. How was your experience working with Cantieri delle Marche throughout the project?**

Excellent, family atmosphere, good communication, trustworthy.

**15. What do you think sets CdM apart from other yacht builders?**

The team and quality of the technical aspect of the vessels.

**16. Would you consider building with them again in the future?**

Yes!



CANTIERE  
DELLE MARCHE  
explorer's attitude

**D a r w i n** 102  
C L A S S





## ABOUT PERSONAL REFLECTION

**17. What emotions did you feel seeing the yacht touch water for the first time?**

Pride, reward (efforts past), hope.

**18. What does this yacht represent to you personally: freedom, adventure, legacy?**

Freedom, the sea is my happy place and the way we will see the world for the rest of our lives.



**19. If you could name one feature that best expresses your personality on the boat, what would it be?**

We will not have art other than a sculpture on board and we will use the wallpapers, veneer panels (sky lounge) and V&C lighting as our art. Choosing every dressing item means I love each piece and I will get joy from this as I do in our other homes.

**20. What advice would you give to someone considering building a yacht of this scale?**

Be clear on your objectives, where and how you want to travel with the boat. Appoint a good design team and add your personality especially to the dressing. Ensure a good surveyor and a build captain. Enjoy the process.







PROFILE

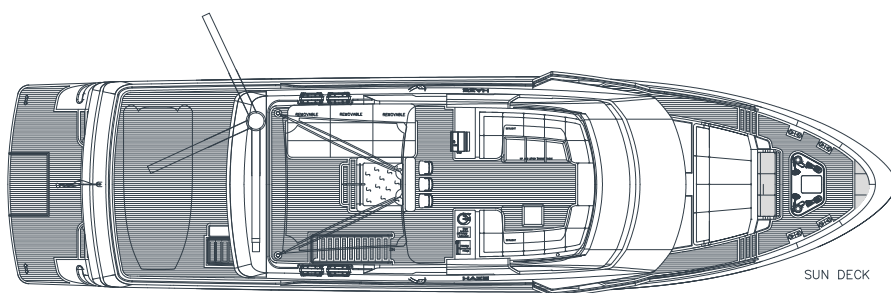

SUN DECK

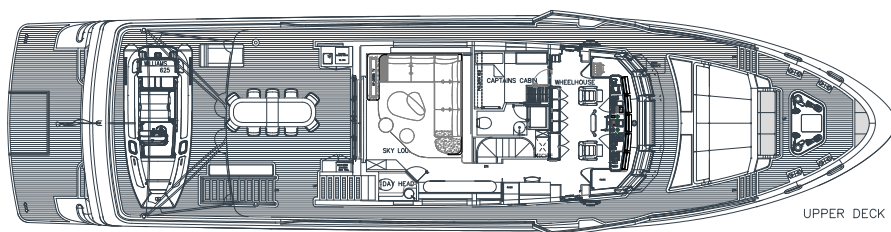

UPPER DECK

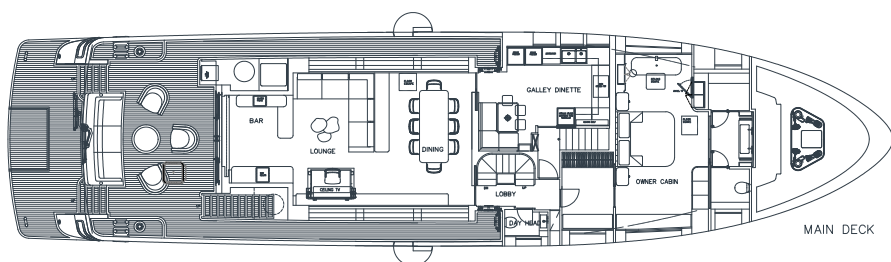

MAIN DECK

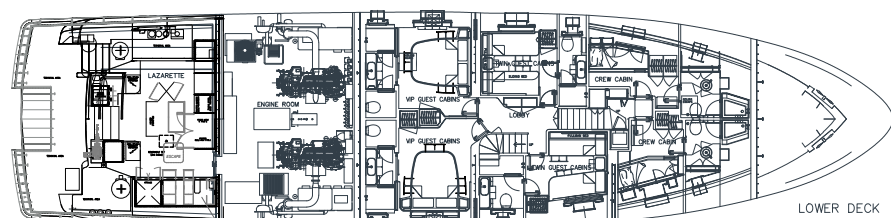

LOWER DECK

## Technical specifications

### DIMENSIONS

**Lenght overall**  
30.8 m

**Waterline lenght**  
28.02 m

**Max beam**  
7.42 m

**Draught, full load**  
3.01 m

**Displacement, full load**  
250 t

### PROPULSION

**Engines**  
2xCaterpillar C18 ACERT  
IMO tier III (500kW @ 1.800-  
2.100rpm) Heavy Duty

**Gearbox**  
2xZF W650

**Generator**  
2x55 kW Kohler

**Bow thruster**  
55 kW

**Stabilizer fins**  
Electrical, Zero Speed

### CAPACITY

**Diesel oil**  
41' 866 L

**Fresh water**  
6' 000 L

**Black water**  
1' 083 L

**Grey water**  
6' 947 L

### PERFORMANCE

**Maximum speed**  
13.0 kn

**Cruise speed**  
11.0 kn

**Range**  
5' 000 nm @ 9 knots

### ACCOMODATION

**Passengers**  
10 (+2 pullman bed) / 5 cabins

**Crew**  
6 / 3 Cabins

**Classification**  
C ⌘ HULL • MACH Ych  
Short Range navigation in  
compliance with MYC-2020





CANTIERE  
DELLE MARCHE  
explorer's attitude